

# VISION3

LIGHTING

## MR16 / LED Dual Sign Light **MODEL SL6**

12V 50W Max. ea., Dual MR16 Halogen

12V 8W Max. ea., Dual COB LED w/ Driver

### Specifications

#### Material

Machined 6061-T6 aluminum with 18-8 stainless steel hardware.

#### Head

Machined heads come in two styles: Side Mount and Rear Mount. (See illustration for aiming capabilities of each head.)

#### Stem

1" diameter machined stem comes in various stem lengths and three stem styles: Straight, 180° U-Bend, and 90° Gooseneck. (See illustration for calculating overall projection from wall for each stem style.)

#### Knuckle

A Rotate and Lock knuckle (protected under U.S. Patents #6,966,679, #7,108,405 and #7,458,552) mounts each head and allows for adjustability. Double taper design allows fixture to hold position during aiming and ensures a solid lock when tightened. Molded silicone wire seals prevent water entry around wires at knuckles.

#### Cap

Each machined cap locks in place with an 18-8 stainless steel set screw and is sealed to the body with a high temperature silicone O-ring. Regress Lens caps have drain holes for water drainage from top of lens if mounted in the up position. 'Flush Lens' cap styles incorporate a stepped lens to reduce the collection of water and debris on the lens. Each cap accepts up to two internal accessories, held in place by a stainless steel clip.

#### Mount Canopy

Available with MO3 (Machined Round Canopy), MO15 (Machined Square Canopy), and MO12 & MO13 (Surface Mount)



Powered Canopies) mount options. See mount specification sheets for more information. (Mount canopy must be mounted to an appropriate wall or junction box, in such a manner that is capable of holding the weight and torque created by the fixture. Junction box and hardware not included).

#### Finish

TGIC thermo set polyester powder coat paint available in 14 standard colors. Finish is applied over a corrosion resistant, hexavalent chromium free, RoHS compliant coating. Also available in one additional metal finish: Clear Anodized.

#### Lens

Tempered, clear lenses, secured to caps with a high temperature, UV curing, silicone adhesive.

#### Socket

Two GY-6.35 porcelain sockets with 600V, 250°C, PTFE coated 18 ga leads (for bi-pin lamp options only).

#### Light Engines<sup>8</sup>

**COB LED:** Both COB LED light engine options use industry standard replaceable components for ease of field maintenance and future upgrades and includes features like: field changeable optics (15°, 24°, 36°, 55°, 65°), choice of color temperature (2700K, 3000K, 3500K, 4000K), CRI (80, 90), and an L70 > 40,000 hrs.

**Integral Driver COB LED:** Each head includes a field replaceable low voltage driver in three current choices for 400lm, 700lm, or 1000lm nominal light output. Driver features include: 12VAC input (+/- 10%), ELV and MLV phase dimming (contact V3 for

dimmer compatibility), high power factor (> 0.9), and internal protection (short circuit, overload, thermal, auto-reset).

#### Remote Driver COB LED:

Each head requires a 350mA max. Vision3 approved constant current driver (see Ordering Information below for dual driver mount options). Each head has a nominal light output of 1600lm (with 15W max., 350mA driver). Note: see specification sheet of Driver Mount being specified for appropriate driver ratings and inputs.

**MR16 Halogen:** Two 12V bi-pin lamps up to 50W each. Lamp supplied by others.

**Retrofit MR16 LED:** Two 12V 7.5W (600lm) bi-pin retrofit Soraa™ MR16 LED lamps with specially engineered heat sink mounts to ensure proper heat transfer to body. Note: Retrofit LED will overheat without supplied heat sink mount.

#### Certification

CSA tested & certified to US and Canadian safety standards for wet location wall mount use per UL1598 (Must be mounted in such a manner to properly support the fixture).

#### Integral Driver COB LED:

**Integral Driver COB LED available in all configurations.**

#### Remote Driver COB LED:

**350mA max driver current each head.**

#### MR16 Halogen:

**50W Max. each head.**

All ratings subject to change without notice. See website or contact V3 for most current info.

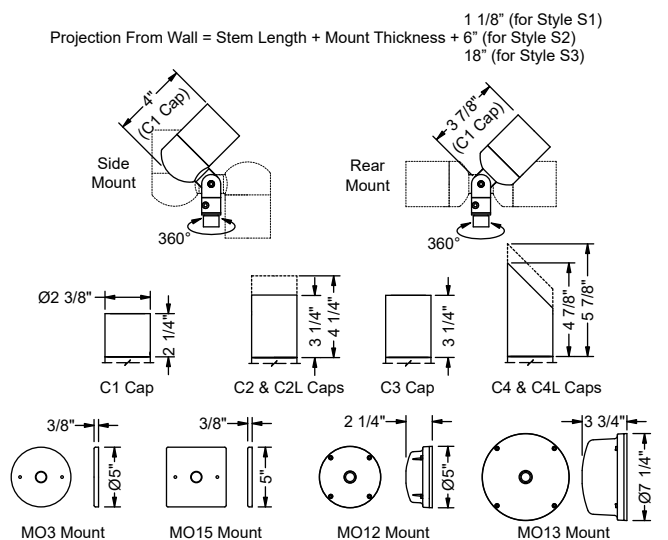
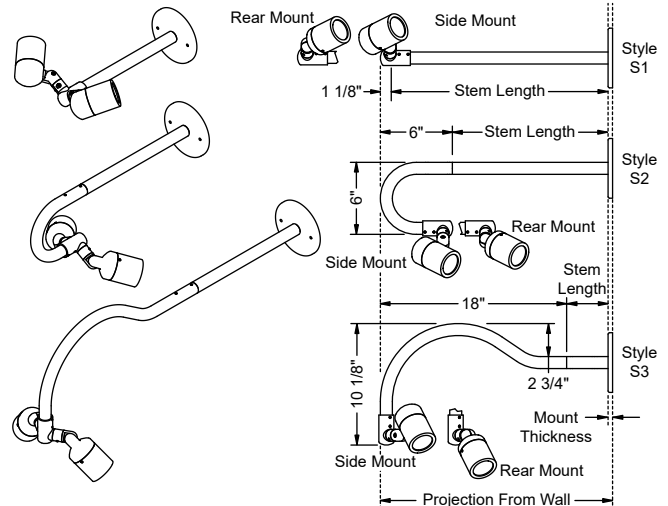

### Ordering Information

SL6A		Head		Cap Style <sup>3</sup>	Style	Mount <sup>2</sup>	Light Engine <sup>8,9</sup>	Lens Accy <sup>4,9</sup>	Louver <sup>4,9</sup>
Model	Finish	SM - Side Mount RM - Rear Mount							
SL6A - Aluminum									
	<b>Powder Coat Finishes:</b>			<b>Standard Lens:</b>	<b>S1 - Straight</b>	<b>Low Voltage Mounts (Remote Transformer Required):</b>	<b>MR16 Halogen:</b>	<b>0 - None</b>	<b>0 - None</b>
	BLT - Textured Black	BL - Black	C1 - Flush	S2 - 180° U-Bend (12" to 42" stems)	S2 - 180° U-Bend (12" to 42" stems)	MO3 - Round Canopy	0 - None (lamp by others)	L1 - Spread	H1 - Hex
	BNT - Textured Bronze	BN - Bronze	C2 - Regress Lens	S3 - 90° Gooseneck (up to 30" stem)	S3 - 90° Gooseneck (up to 30" stem)	MO15 - Square Canopy	<b>Retrofit MR16 LED:</b> <sup>4,5</sup>	L2 - Linear	
	BAT - Textured Bark	WI - White	C2L - Regress Lens, Long			MO12 - Surface Mount Canopy	155 - 7.5W, 600lm, 90CRI, 3000K, 10°	L3 - Softening	
	GRT - Textured Green	SI - Silver	C3 - Regress Lamp			<b>Line Voltage Mounts (Integral Transformer):</b>	156 - 7.5W, 600lm, 90CRI, 3000K, 25°		
	GNT - Textured Granite	GY - Grey	C4 - 45° Angled			MO12-75-120 - MO12 w/ 75W, 120V	157 - 7.5W, 600lm, 90CRI, 3000K, 36°		
	SAT - Textured Sand	BE - Beige	C4L - 45° Angled, Long			MO12-75-230 - MO12 w/ 75W, 230V <sup>5</sup>	<b>Amber MR16 LED (Turtle Safe):</b> <sup>5</sup>		
	PAT - Textured Patina		<b>Flush Lens:</b>			MO12-75-277 - MO12 w/ 75W, 277V <sup>5</sup>	AM1 - 5W, 380lm, 85CRI, 30°, Turtle Safe Amber <sup>4</sup>		
	EAT - Textured Earth		C1F - Flush			<b>Dual Driver Mounts (Remote Driver COB LED only):</b>	<b>Integral Driver COB LED:</b> <sup>6,8</sup>		
	<b>Metal Finishes:</b>		C2F - Regress Lens			MO13-2X15-UNV-350-TRI - MO13 w/ Dual 15W, 120-277V, 350mA	LE2 - XXXX - X - XX - XX		
	CLA - Clear Anodized		C2LF - Regress Lens, Long						
			C3F - Regress Lamp						
			C4F - 45° Angled						
			C4LF - 45° Angled, Long						

#### Notes:

- Other stem lengths available upon request. Contact Vision3.
- See mount specification sheets for mount details.
- Use only approved 7.5W Retrofit MR16 LED lamps and supplied heat sink mount, otherwise LED may overheat.
- AM1 Turtle Safe Amber LED can only be specified with 1 lens accessory.
- Retrofit LED, Amber LED, and Integral Driver COB LED options may not be compatible with MO12-75-230 and MO12-75-277 mounts. Only
- power LED Light Engine options with approved transformers (contact V3 for mount, transformer, and dimmer compatibility info).
- Integral Driver COB LED Light Engine options do not require a separately specified remote driver. See specifications above for required voltage input.
- Remote Driver COB LED Light Engine options must be used with Dual Driver Mounts shown.
- All lumen values cited are nominal lumen output (ideal lumen output of

- light engine only in lab conditions). Actual fixture output will vary with cap type, material, lens/optics options, and environmental conditions. For more accurate information, see fixture photometry files on website.
- Cap Style, Light Engine, Lens Accy, and Louver options specified will be used for each head. To use different options for each head, contact Vision3.
- Specifications, certifications, and ordering information are subject to change. Please check website for latest specification sheets.

#### Remote Driver COB LED (requires Driver Mount):<sup>7</sup>

CO2 - X - XX - XX	CRI	CCT	Optics
8 -> 80	27 - 2700K	15 - 15°	55 - 55°
9 -> 90	30 - 3000K	24 - 24°	65 - 65°
	35 - 3500K		36 - 36°
	40 - 4000K		

Example: **SL6A - BN - SM - C1F - S1 - 18 - MO3 - LE2-1000-90-40-65 - L2 - 0**